

# E.T. Full Moon 10K

Race Website: [www.calicoracing.com](http://www.calicoracing.com)  
 as of date of measure: 7/21/08  
 Extraterrestrial Highway  
 Rachel, NV

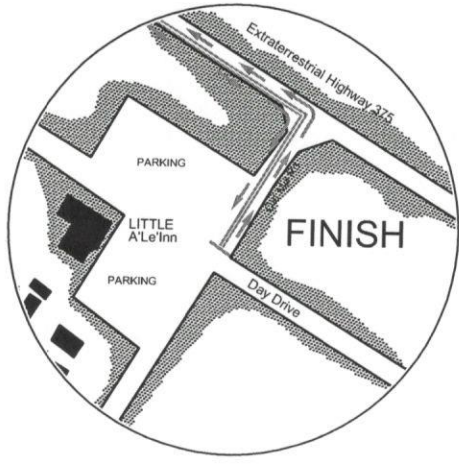
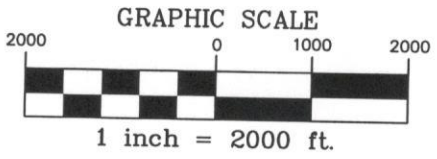

COURSE is to scale

Runners must stay between the edge of pavement and the 5" wide white road stripe.

Headlamps or flashlights are required at all times.

At NO time will runners be allowed to enter the travel lanes of traffic.

All intersections are shown.

ELEVATIONS:	
Start:	4839'
<u>High:</u>	
0.1 M marker	4840'
<u>Low:</u>	
1.2 & 5 mi	4773'
Elevation Gain:	156'

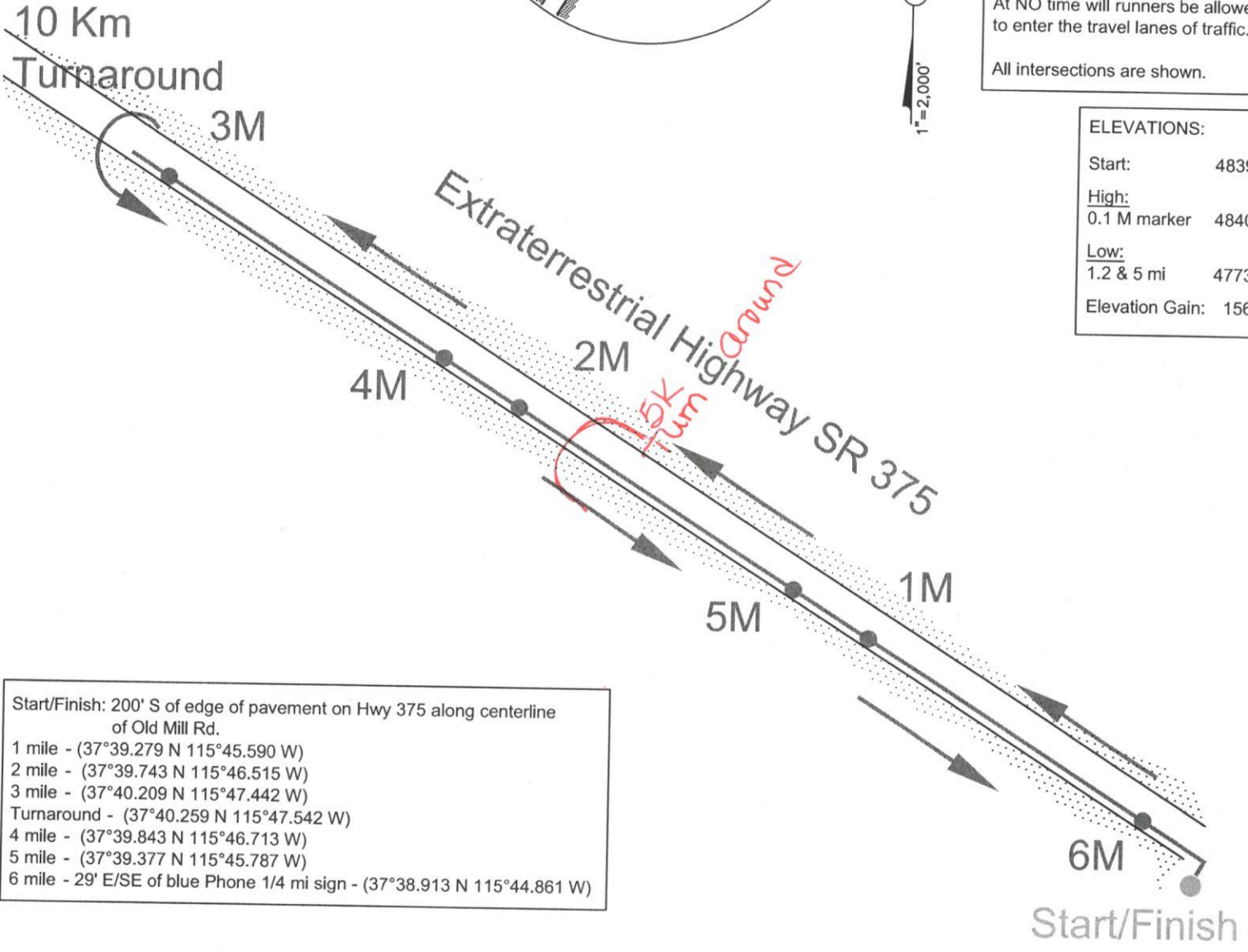

Start/Finish:	200' S of edge of pavement on Hwy 375 along centerline of Old Mill Rd.
1 mile -	(37°39.279 N 115°45.590 W)
2 mile -	(37°39.743 N 115°46.515 W)
3 mile -	(37°40.209 N 115°47.442 W)
Turnaround -	(37°40.259 N 115°47.542 W)
4 mile -	(37°39.843 N 115°46.713 W)
5 mile -	(37°39.377 N 115°45.787 W)
6 mile -	29' E/SE of blue Phone 1/4 mi sign - (37°38.913 N 115°44.861 W)

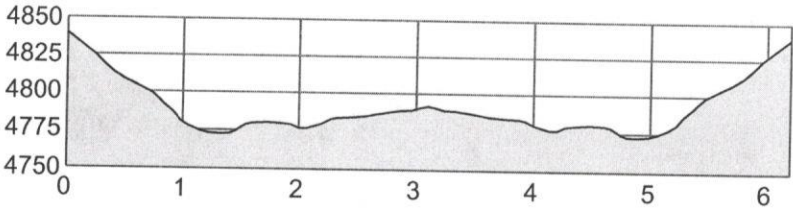

Rachel  
NV